

# INDUSTRIAL/WAREHOUSE SPACE FOR LEASE



47 ANTARES DRIVE



**JENNINGS**  
**REAL ESTATE**  
BROKERAGE INC.

# OFFERING SUMMARY

AVAILABILITY	SPACE USE	SIZE	NET RENT	ADDIT. RENT
Immediate	Industrial/Warehouse	Up To 53,410 SF	\$13.50 PSF	\$8.06 PSF + utilities (2025 Est.)

## PROPERTY HIGHLIGHTS

- The demising options are as follows: 8,000 SF, 21,400 SF and 24,000 SF
- Building is serviced by 1000kVA pad mount transformer with a main breaker rated at 1200amps 347/600v
- Completely temperature-controlled warehouse space
- Conveniently located along Hunt Club Road, just minutes from the Ottawa International Airport
- Two 12' x 12' oversized grade level loading doors, with interior dock levelers
- Two regular 8' x 8' grade-level doors
- Approximately 9% finished office, with 91% warehouse
- 16' clear height to underside of beam, 18' clear height to roof joist
- Fully sprinklered building

# 47 ANTARES DRIVE









# ENTIRE BUILDING FLOOR PLAN

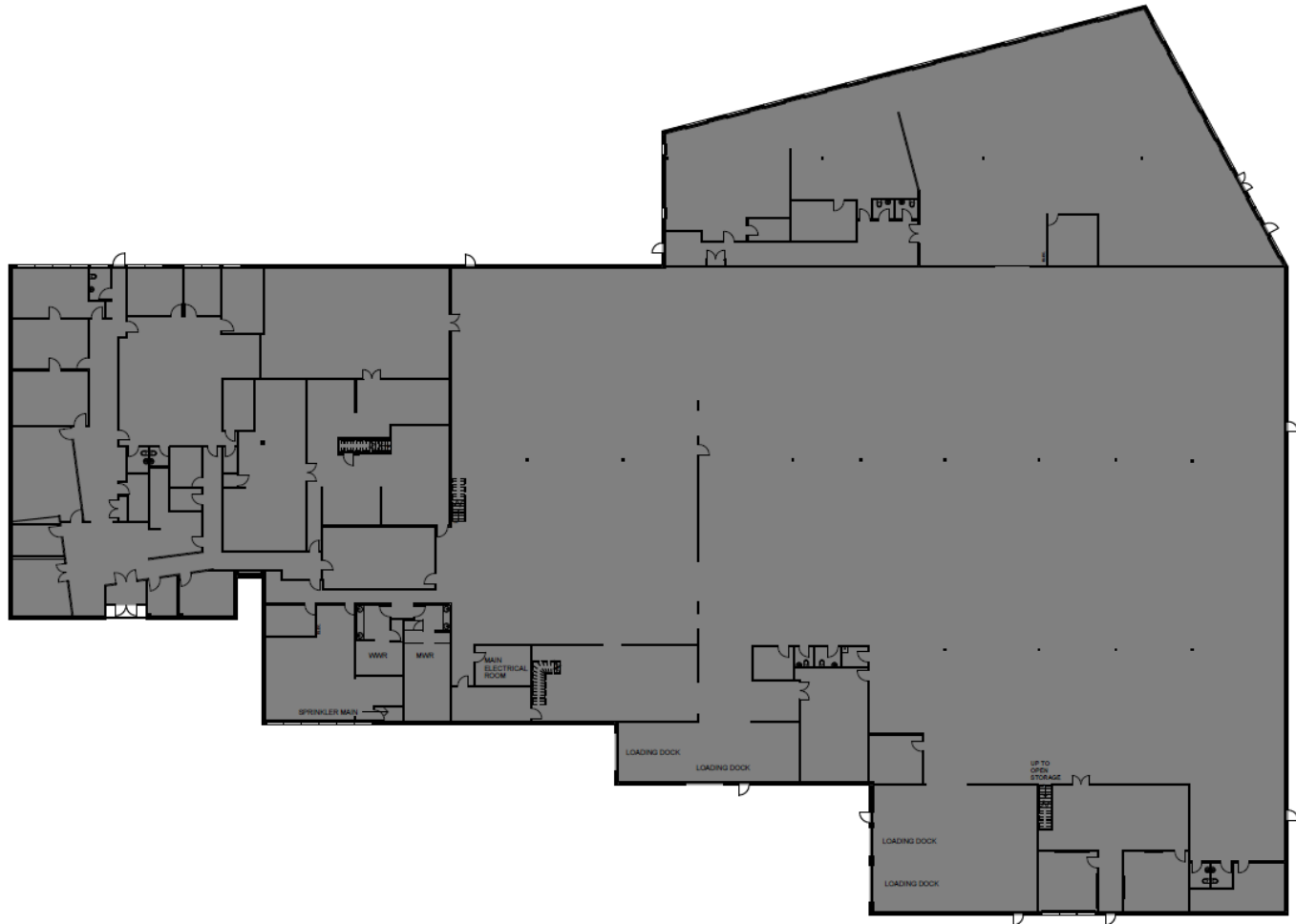

47 ANTARES DRIVE

# DEMISED FLOOR PLAN

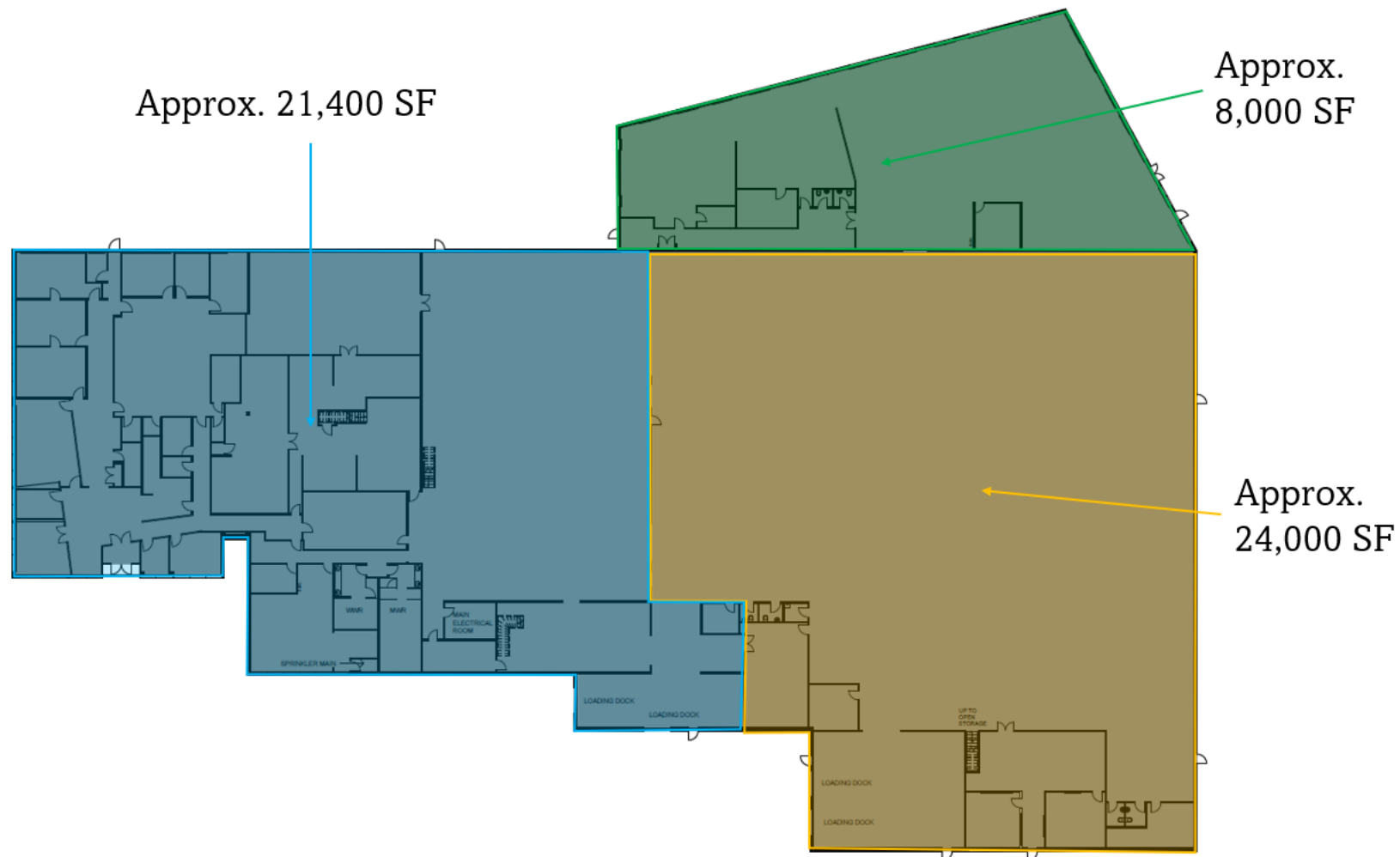

## 47 ANTARES DRIVE



# MAP

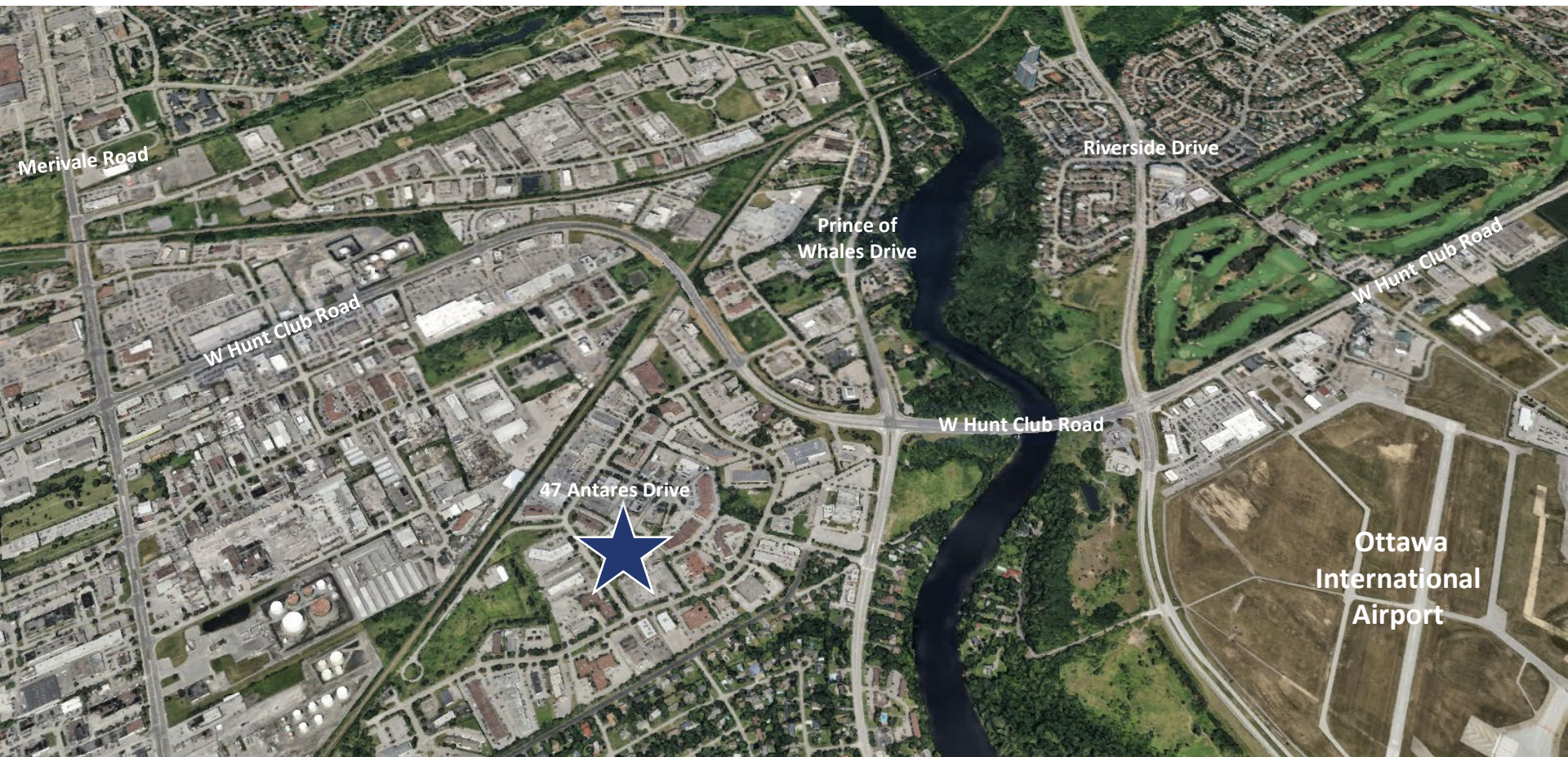

## 47 ANTARES DRIVE





Contact: Jennings Real Estate Brokerage Inc.

Andrew Eberhard | Broker of Record  
613-709-0263 | [aeberhard@jre.ca](mailto:aeberhard@jre.ca)

Iryna Loshkarova | Sales Representative  
613-413-1361 | [iloshkarova@jre.ca](mailto:iloshkarova@jre.ca)



**JENNINGS**  
**REAL ESTATE**  
BROKERAGE INC.